



Neumärker

Lohstr. 13 - 58675 Hemer / Postfach 4063 - 58663 Hemer
Telefon: +49 2372 9274-0 Fax: +49 2372 3304
DEUTSCHLAND

Operating Manual

**Ceramic Glass
Salamander PDS**

Art.-Nr. 05-50370

www.neumaerker.de

SALAMANDER PDS

Congratulations for the acquisition of this upmarket appliance. You chose an appliance which alloys the best technical qualities with a big user-friendliness. We wish you the biggest contentment.

1. SECURITY INSTRUCTIONS

Please respect these instructions scrupulously to avoid any risk of fire, electric shock, scald or other wounds and damage. During the use of this appliance, fundamental circum-spection of security must always be noticed, such as:

- Take into account the instructions to be systematically kept with the appliance.
- Install the appliance always in instructions respect. A 50 cm distance minimum with the partition or the wall is necessary (except on the rear part).
- Protect the appliance from direct light of the sun, frost and humidity.
- Never leave the appliance within the reach of children or disabled persons without surveillance.
- Ensure that only trained personnel operate the appliance.
- Never move the appliance when it is working or when the cooking surfaces are still hot.
- Check that the appliance is definitely off before connecting it up or disconnecting it.
- Do not touch the hot surfaces of the appliance. The temperature of the hot surfaces can be very important when the appliance is working.

Always use handles and control knobs.

- Do not use the appliance for other functions than determined use.
- Do not leave the cord of electrical feeding in the contact of hot surfaces.
- The appliance should not be used close to combustible materials.
- During use, look after not to obstruct hearings of aeration of the appliance.
- To avoid any electric shock, never plunge the appliance, the cord or plug in water or quite other liquid.
- If the cord is harmed, it must be replaced by the producer, his after sale service or persons of similar skills to avoid any risk.
- Entrust compensations only to a skilled person.
- Use only spare parts of origin.
- At the end of cooking, before cleaning the appliance, do not forget to disconnect it.

2. CONTENTS OF CARDBOARD PACKAGING

Device: a salamander

Accessories: - A tray

- A grid

- The present note

See exploded view at the end of the document.

3. CONFORMITY OF USE

Use the device only to defrost, brown, glaze, grill toasts, gratins, pizzas, onion soups... without pre-heating.

4. WAY OF FUNCTIONING

This salamander is fitted with two cooking areas, a removable inside tray with a grid, a commutator to select the cooking zone, an energy regulator to set the power and a plate detection system (PDS).

The top of the salamander is movable and enables you to adapt the cooking position to grill, glaze or brown your foodstuffs.

To turn on the salamander, just set the commutator (n°5 on picture) on one of the position according to the desired cooking zone to be used, set the energy regulator (n°2 on picture) on the desired power (the position C enables to obtain a continuous heating power).

Your salamander is fitted with a plate detection system (PDS/n°1 on picture). When the commutator is on position **Start**, the heating will automatically work when you place a plate or tray in contact with the plate detection system (n°6 on picture). To use this function, the energy regulator (n°2 on picture) has to be set on C position. If the PDS commutator (n°1 on picture) is on position 0, your salamander is running continuously and is regulated by the energy regulator.

The green pilot light (n°4 on picture) indicates the salamander is on. The orange one (n°3 on picture) indicates the salamander is heating up.

Position 1 : Left area

Position 2 : Right area

Position 3 : Complete area.



1 PDS commutator

2 Energy regulator

3 Control pilot light

4 On/off pilot light

5 Commutator

6 Plate detection system (PDS)

5. FUNCTIONING / MANIPULATION

a) Installation / assembly:

- Unpack carefully the device of its packaging.
- Place the salamander on a plane and heatproof surface.
- Never place the device near a wall or near a partition made of combustible materials even if it is very well isolated.
- A distance of minimum 50 cm with the partition or the wall is necessary (except on the rear part)
- Remove the protective film from the top, the rear, the sides and the tray.
- Unlock the movable top by unscrewing the screw located on the back of the machine thanks to a 10 pipe key.
- In case of connection directly to the electrical network, a disconnection mode has to be planned in conformity with the norms.

CAUTION :

During use: never place the machine on surfaces or near walls, partitions or kitchen furniture and similar— except if they are made with a non combustible material or recovered with non combustible thermic insulation, and pay attention to fire preventions rules.

b) First starting:

During the first use, warm your machine up outside to evacuate residual smokes of manufacturing oil from the metallic parts. This may emit a slight smell for a few moments.

First cleaning

Clean the device before the first use. (See 6. Cleaning)

Connection of the device

- Check that the tension and the frequency of the electricity network suit to the values indicated on the descriptive plate.
- Make sure that every control knob is positioned on 0.
- Unwind completely the electric power cable and connect it in a plug connected with the earth.
- The device is connected.

NB: in case of connection of the device in a plug without earth protection or directly on the electricity network, confide its connection to a qualified person .

c) Use of device :

Elements of command and display

Command/Display	Function
PDS commutator (n°1 on picture)	Plate detection system on/off
Energy regulator (n°2 on picture)	Regulates the heating power
Orange pilot light (n°3 on picture)	Heating up (pilot light on)
Green pilot light (n°4 on picture)	On/off for each cooking area (pilot light on)
Commutator 4 positions (n°5 on picture)	Cooking area selection

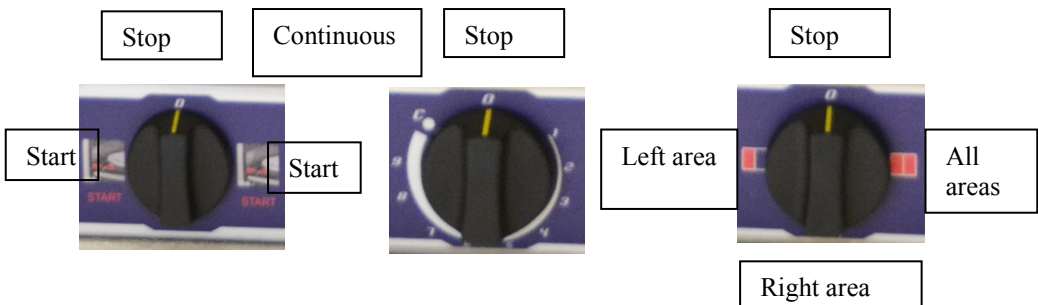

Putting on

Turn on the commutator control knob (n°5 on picture) on wished position according to desired cooking zone to be used and the energy regulator (n°2 on picture) on wished power.

The pilot lights (n°3 and 4 on picture) ignite.

To use the plate detection system (PDS), set the commutator on Start position and the energy regulator on position C.

The cooking with infrared radiation does not need preheating.

Stopping the appliance

Set the commutator control knob, the PDS commutator and the energy regulator on 0

Disconnect the power cable.

Let the device cool down

Clean the appliance. (see 6. Cleaning)

d) Breakdown / repair:

In case of breakdown or of damaged part, please call your after-sales service and confide any technical operation to qualified person.

When you contact the after-sales service of your distributor or your store, give him the complete reference of your device (commercial name, type and serial number). This information appears on the visible descriptive plate behind the device.

6. CLEANING AND MAINTENANCE

Disconnect the device.

- Let cool completely the device before any technical intervention or cleaning.
- Never clean the ceramic glass when it is hot.
- Clean regularly the external walls of your device with warm water and wash liquid: avoid the abrasive towelling. Rinse your device with a wet sponge.
- Never clean the device under a water jet, the infiltrations would risk to damage it in a irreparable way.
- Never immerse the device, the cord or the plug in the water or quite other liquid to avoid any electric shock.
- During a prolonged non-use, we recommend you strongly to keep the device shielded from the humidity.

7. TECHNICAL SPECIFICATIONS

Model	Salamander PDS
Voltage	220-240 V ~
Current	13 A
Power	3000 W
Weight	56 Kg
Nb element	2
Cooking surface	495x375 mm
Outside dimensions	600x640x590 mm

We recommend to connect this equipment on a power socket of a capacity of 16A minimum

Wires colours correspondence

Phase
Neutral
Earth

Brown / Black / Grey
Blue
Yellow-Green



The equipotential connection marked by this symbol must be linked with the equipotential conductive connection of your installation by means of a minimum conduction of a 2.5 mm² section.

8. NORMS AND LEGALS DISPOSALS

The device is conform to :

IEC/EN 60335-1
IEC/EN 60335-2-48
EN 55014-1 + 55014-2
EN 61000-3-2 + 61000-3-3

Humidity protection degrees IPX3, in conformity with the norm 60335-2-48 (2008)

9. ELIMINATION OF THE ELECTRIC AND ELECTRONIC WASTE

The device respects the directives:

2002/96/CE (DEEE) N°34270064800021
2002/95/CE (ROHS)
2066/95 CE
2004/108 CE



Reach rule

Never put the device among household waste.

The device must be put down in a centre of recycling for the electric equipments.

The materials of the device are indeed reusable. By eliminating correctly the electric and electronic wastes, the recycling and quite other shape of re-use of worn equipments, you participate in a significant way in the environmental protection.

For any information about the collection of electric and electronic waste, please contact your distributor.

10. GUARANTEE

Conditions of guarantee

The guarantee applicable to any device is the commercial guarantee of the distributor or the retailer. Please contact the store where you bought your device to know the precise conditions.

The guarantee grants no right for damages.

The dispositions which follow are not exclusive of the profit of the legal guarantee planned by articles 1641 and following ones of the Civil code relative to the defects and the latent defects.

Exclusion clauses of the guarantee

Bad installation and bad maintenance, in particular if they do not respect current regulations or instructions appearing in this user guide.

Cannot benefit from the guarantee the repairs required as a result of false operations, of inappropriate use, of carelessness or of excess loads of the device, as well as those resulting from variations of the power supply, over tension or from defective installations.

The damage due to shocks, bad weather is not flatware by the guarantee. The material travels at the risks of the user; in case of delivery by carrier, the consignee has to have reservations towards the carrier before any delivery of the device.

The guarantee comes to an end in case of intervention, of repair, of modification by no qualified persons, or of use in inappropriate purposes.

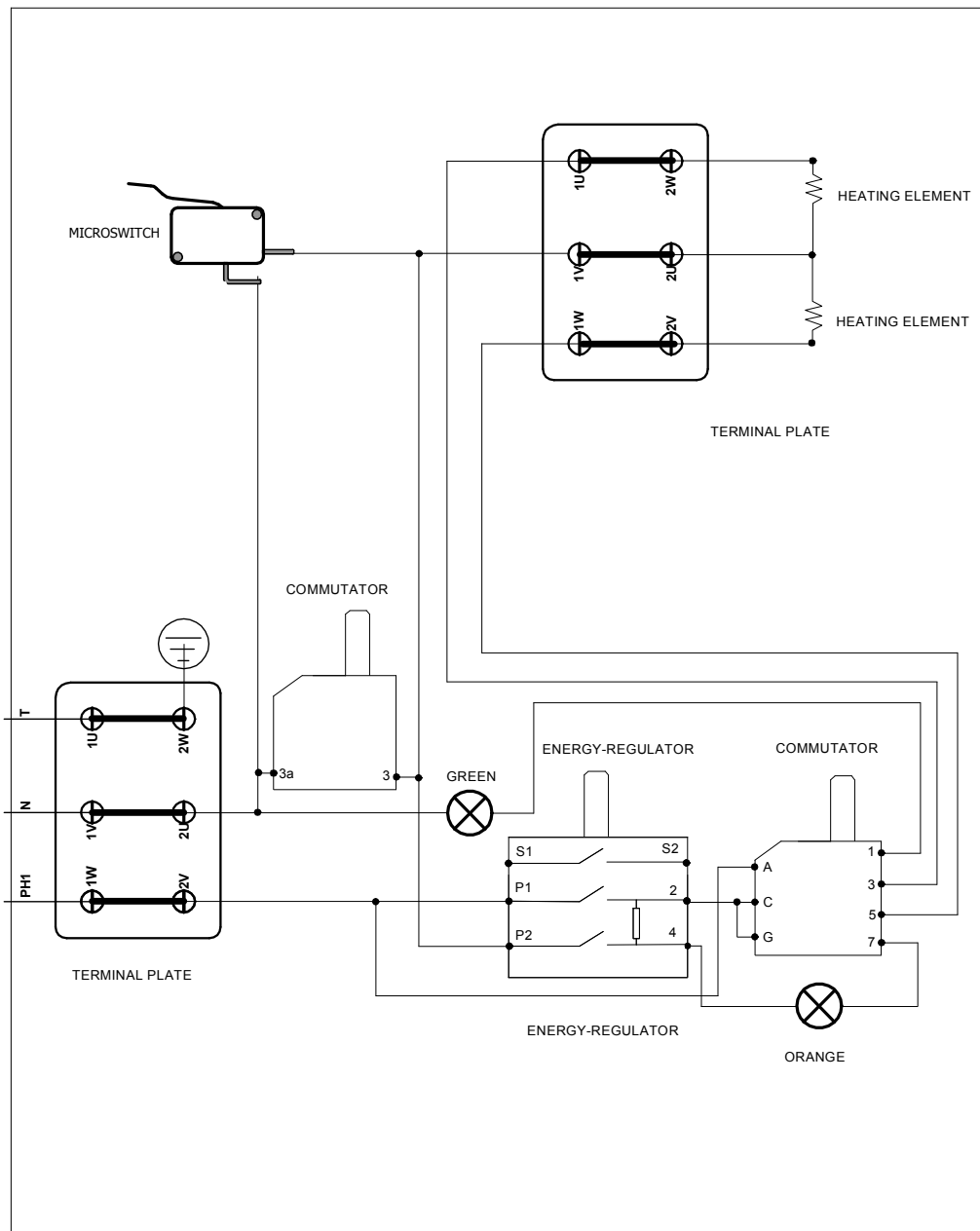

SEM 600 PDS 3000 W

Date :
31/08/2016

Date :
31/08/2016

CODE	QTE	SPARE PART
70094	18	WEIGHT AGAINST SALAMANDER
70097	1	WEIGHT COUNTER LOCK SEM/SGM 600
70098	1	BACK CASING SEM/SGM 600
70099	1	FRAME HOLDER SEM 600
70100	1	REAR COVER SEM 600
70102SE	1	BOTTOM CASING
70104SE	1	WEIGHT COUNTER HOLDER
70105	1	TRAY SEM/SGM 600
70111	1	DEFLECTOR SEM/SGM 600
70112	1	ROOF SEM 600
70114	10	BACK AGAINST WEIGHT SEM 60 VC
70122SE	1	TRAY SENSOR REF A SEM 600 PDS
70123	2	TRAY DETECTOR REF B SEM 600 PDS
70124	1	MICROSWITCH HOLDER REF A SEM 600 PDS
70125	1	MICROSWITCH HOLDER REF B SEM 600 PDS
70126	1	REAR SEM 600 PDS
70127	1	BASE SEM 600 PS
70128	1	CERAMIC CHAMBER SPACER SEM 600 PDS
70129	2	CERAMIC CHAMBER LOCK SEM 600 PDS
70130	1	REFLECTOR SEM 600 PDS
72054D	1	RIGHT WIRE HOLDER SEM/SGM
72054G	1	LEFT WIRE HOLDER SEM/SGM
72059	1	LEFT BEARING HOLDER SEM/SGM
72060	1	RIGHT BEARING HOLDER SEM/SGM
72061SE	1	LEFT ROOF HOLDER SEM/SGM 600-800
72062SE	1	RIGHT ROOF HOLDER SEM/SGM 600-800
72063	1	DOMINO HOLDER SEM 600/800
72064	2	INSIDE UPRIGHT SEM/SGM 600-800
72075	1	HANDLE SPACER SEM/SGM 60-80
72084D	1	RIGHT CHAIN COVER SEM/SGM 600-800
72084G	1	LEFT CHAIN COVER SEM/SGM 600-800
A01001/1	1	COMMUTATOR 4924215001
A01015	1	COMMUTATOR RE 2
A04006	1	REGULATOR
A07037	1	MICROSWITCH 20 A. 250 V
A08003	1	ORANGE PILOT LIGHT DIAM 12
A08009	1	GREEN PILOT LIGHT DIAM 12
A10032	1	CORD CLOSER
A12002	2	CABLE SHOE DA 200, RF14, RG8
A12003	4	CABLE SHOE CA
A12011	2	CABLE SHOE DA 110
A13003	2	RUBBER FOOT
A13006	4	FOOT
A14078	3	KNOB 12 H FOR ELECTRIC
A15018	1	HANDLE SALAMANDER
A16010	2	TERMINAL PLATE
B01002	4	GEAR WHEEL
B04098	6	BEARING AXLE SEM 800/SEM 600
B04099	2	WEDGE ADJUSTMENT SEM 800/600
B04100	2	BEARING HOLDER SEM 800
B06004	4	PIN SLIT 3.2 x 25
B06009	2	STUD + NUT
B06017	10	BEARING
B06060	1	MICROSWITCH AXLE SEM 600 VC PDS
B07001	4	COMPRESSION SPRING
B07004	2	SPRING
B07028	2	CHAIN
C03P05411	1	CORD
C05018	1	EQUIPOTENTIAL TERMINAL
D06009	2	CERAMIC CHAMBER 1500 W
F01071	1	GRID SEM/SGM 600
F02007	2	TRAY SLIDE
G06P05411	1	FRONT PANEL
H01073	1	GLASS CERAMIC SEM 600
I17001	1	STAINLESS STEEL SCREW 4 x 8
I18011	2	NUT DIAM 4
TP0010_556	2	GEAR WHEEL HOLDER AXLE

SEM 600 PDS 3000 W

Date :
31/08/2016

Date :
31/08/2016

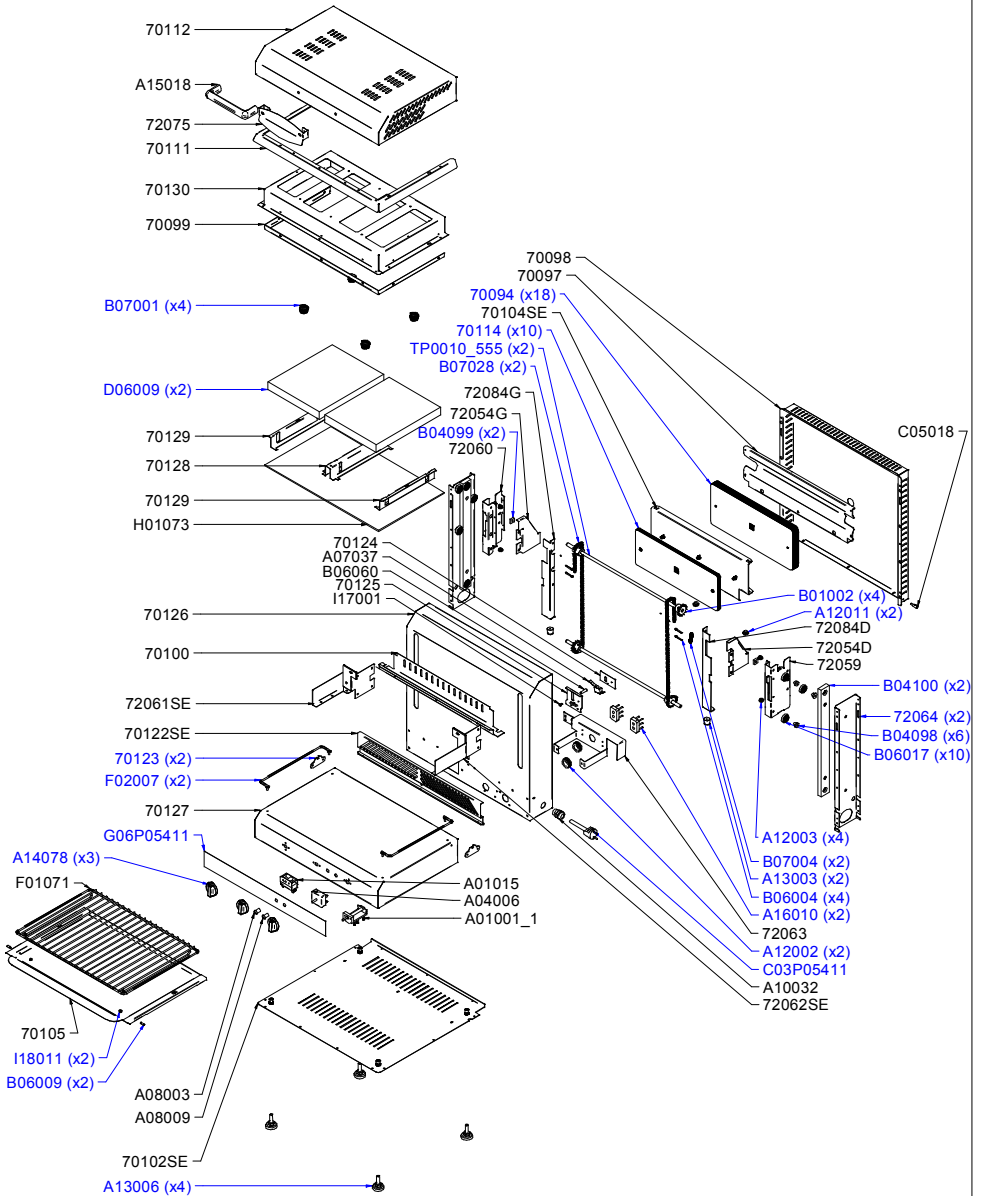

SEM 600 PDS 3000 W

Date :
31/08/2016

Date :
31/08/2016